

REDUCED, BELOW-MARKET RATE!

100 LARKSPUR LANDING CIRCLE | LARKSPUR, CA



±1,750 SF CLASS "A" OFFICE SUITE AVAILABLE



EXCELLENT PROJECT AMENITIES

- RETRACTABLE ROOF SYSTEM
- 3 COMMON CONFERENCE ROOMS
- COMMON AREA KITCHEN
- LARGE LOBBY - MULTIPLE SEATING & WORK AREAS
- ONSITE SHOWERS & LOCKERS



CONVENIENT LOCATION

- IMMEDIATELY ADJACENT TO LARKSPUR FERRY TERMINAL
- CONVENIENT ACCESS TO HWY 101 & I-580
- WALKING DISTANCE TO ABUNDANT RETAIL AMENITIES



REDUCED, BELOW-MARKET RATE!

100 LARKSPUR LANDING CIRCLE | LARKSPUR, CA

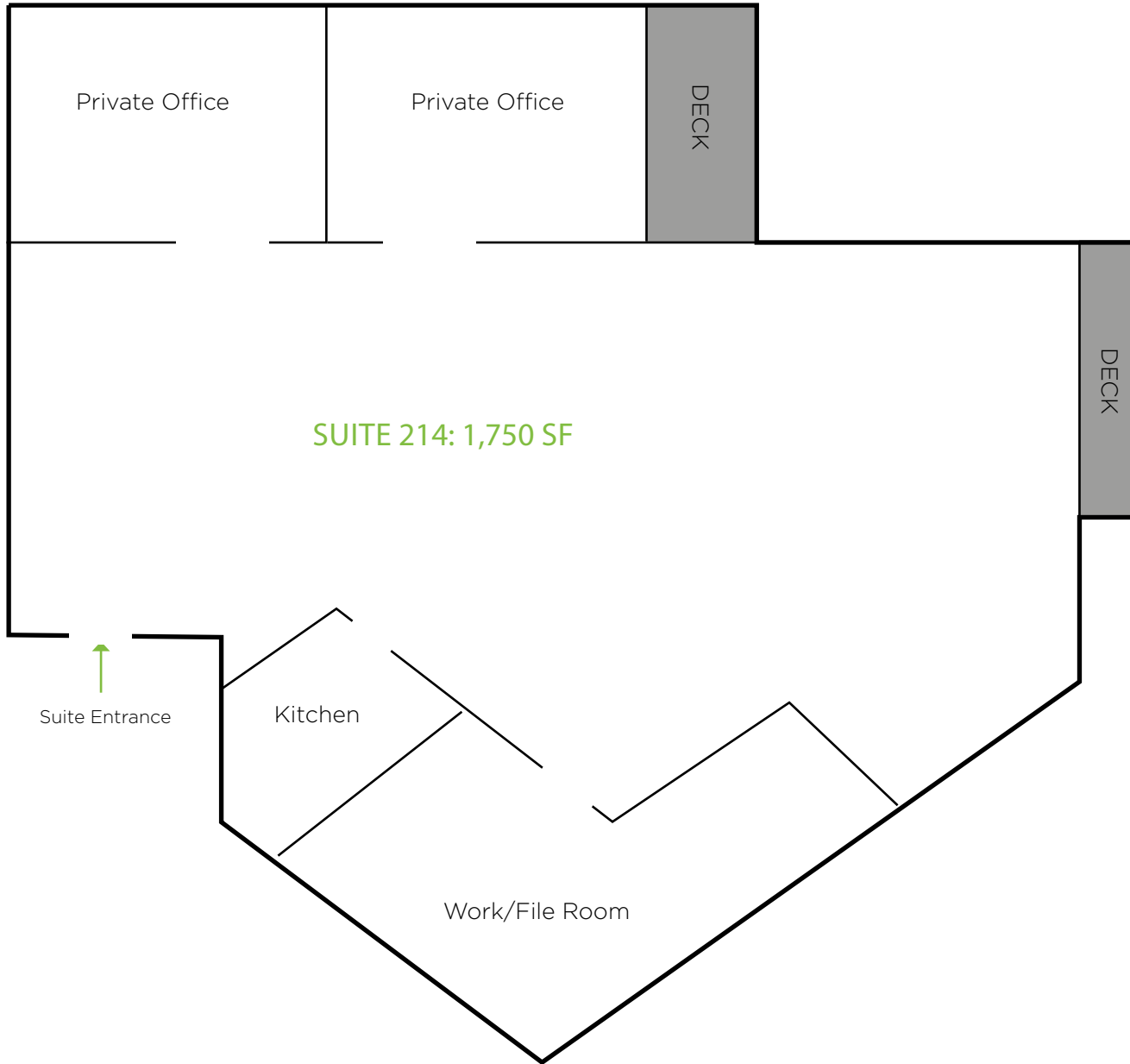

SUITE 214

- 1,750 SF Class 'A' Office Suite for Sublease
- Two Private Offices
- Large Open Work Area
- Large Work/Copy Room
- Kitchen
- Two Private Exterior Decks
- Operable Windows
- Existing Furniture Available
- Sublease Through 10/31/2020
- Asking Rate: \$4.25 psf, Full Service Gross

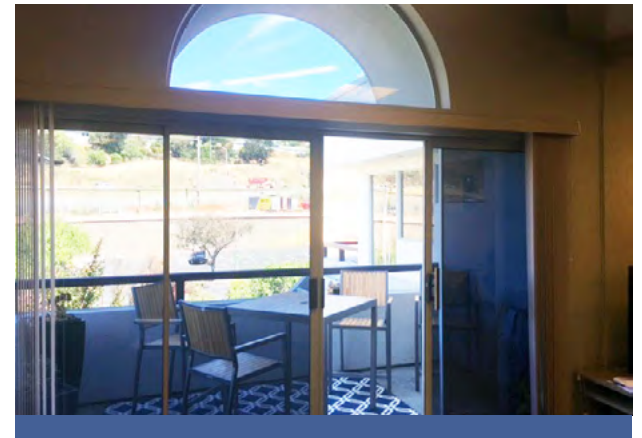

FOR MORE INFORMATION, PLEASE CONTACT:

JORDAN LAZOR
jordan.lazor@am.jll.com
(415) 595 5102
RE Lic. No: 02011117

CHRIS TEWHILL
chris.tewhill@am.jll.com
(415) 747 0798
RE Lic. No: 02034376

GLEN DOWLING
glen.dowling@am.jll.com
(415) 299 6868
RE License No: 0890450



100 LARKSPUR LANDING CIRCLE | LARKSPUR, CA



WALK TO LARKSPUR FERRY TERMINAL & MARIN COUNTRY MART



CONVENIENCE. ACCESS. AMENITIES.

100 Larkspur Landing Circle is located immediately adjacent to the Larkspur Ferry Terminal, providing employees convenient commute and business travel options around the Bay Area. The project is also located just off of Highway 101 and I-580.

Less than a five-minute walk from 100 Larkspur Landing Circle is Marin Country Mart (previously known as Larkspur Landing), an open-air shopping destination comprised of over 173,000 SF of eateries and retail shopping options.

FOR MORE INFORMATION, PLEASE CONTACT:

JORDAN LAZOR
jordan.lazor@am.jll.com
(415) 595 5102
RE Lic. No: 02011117

CHRIS TEWHILL
chris.tewhill@am.jll.com
(415) 747 0798
RE Lic. No: 02034376

GLEN DOWLING
glen.dowling@am.jll.com
(415) 299 6868
RE License No: 0890450



RETRACTABLE ROOF SYSTEM

