

# FOR LEASE

# 1455 N. MCDOWELL BOULEVARD

## PETALUMA, CA



## ±8,376 - ±14,940 RSF OFFICE/INDUSTRIAL SPACE

### AVAILABLE SINGLE UNITS:

- ±2,292 (Unit A)
- ±4,252 (Unit B)
- ±8,376 (Unit C)

### UNIT COMBINATIONS AVAILABLE:

- ±10,668 (Units A and C combined)

### PROJECT HIGHLIGHTS:

- ±35,000 SF Office/Industrial Building
- Warehouse Space Features ±16' - 20' Ceiling Clear Height
- Ample Power Supply
- Abundant Onsite Parking
- Walking Distance to Restaurants and Coffee Shops
- Local and Responsive Ownership
- Amenities Include Volleyball Courts & Walking Paths
- Located in Redwood Business Park - a 1,100,000 SF Business Park in Petaluma's Northeast Corner, just off Highway 101



EXCLUSIVELY LISTED BY: THE DOWLING-BRACCO TEAM OF JLL | [WWW.DBREA.COM](http://WWW.DBREA.COM) | [WWW.JLL.COM](http://WWW.JLL.COM)

# ±8,376 - ±14,940 RSF OFFICE/INDUSTRIAL SPACE FOR LEASE

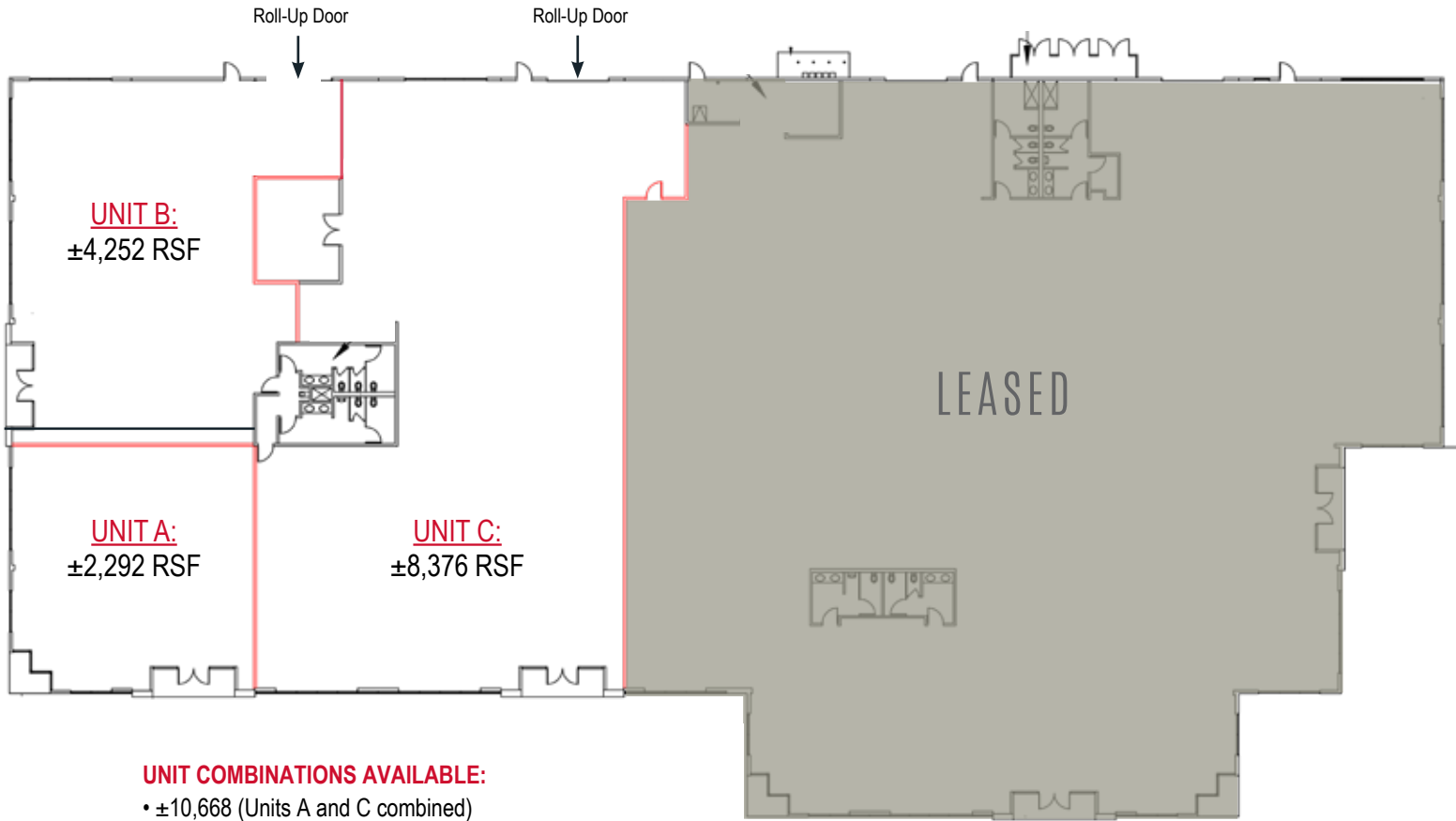

### NEARBY AMENITIES INCLUDE:

- [Redwood Gateway Business Center](#)
- [Beyond the Glory](#)
- [Gohan Sushi](#)
- [El Charro](#)
- [Orchard Plaza Shopping Center](#)
- [Starbucks](#)
- [Subway](#)
- [Cafe Giostra](#)

To Schedule a Tour or For More Information, Please Contact: **THE DOWLING-BRACCO TEAM OF JLL**



TONY SARNO  
tony.sarno@am.jll.com  
M (707) 217 7196  
RE License No: 01430933

GLEN DOWLING  
glen.dowling@am.jll.com  
M (707) 227 7800  
RE License No: 00890450

JORDAN LAZOR  
jordan.lazor@am.jll.com  
M (415) 595 5102  
RE License No: 02011117

CHRIS TEWHILL  
chris.tewhill@am.jll.com  
M (415) 747 07  
RE License No: 02034376